

Dott & Crossitt

Conveyancing + Solicitors

14/1/2026

The following Vendor Disclosures are made pursuant to *Property Law Act 2023* (Qld):

- ☒ Form 2
- ☒ Title Search
- ☒ Plan Diagram
- ☐ Residential Lease
- ☐ Notice issued about a Transport Infrastructure proposal
- ☐ Notice under section 408(2) of the Environmental Protection Act
- ☐ Notice under section 369(2) of the Environmental Protection Act
- ☐ Notice under section 347(2) of the Environmental Protection Act
- ☐ Order or Application under the Neighbourhood Disputes (Dividing Fences and Trees) Act 2011
- ☒ Pool Compliance Certificate
- ☐ Notice of no pool safety certificate
- ☐ Notice under section 47 of the Queensland Building and Construction Commission Act 1991
- ☐ Council Rates notice (optional)
- ☐ Water Rates notice (optional)
- ☐ Form 33
- ☐ Form 34
- ☐ Form 18
- ☐ Copy of other unregistered easement

Seller disclosure statement



Queensland
Government

Property Law Act 2023 section 99

Form 2, Version 1 | Effective from: 1 August 2025

WARNING TO BUYER – This statement contains important legal and other information about the property offered for sale. You should read and satisfy yourself of the information in this statement before signing a contract. You are advised to seek legal advice before signing this form. You should not assume you can terminate the contract after signing if you are not satisfied with the information in this statement.

WARNING – You must be given this statement before you sign the contract for the sale of the property.

This statement does not include information about:

- » flooding or other natural hazard history
- » structural soundness of the building or pest infestation
- » current or historical use of the property
- » current or past building or development approvals for the property
- » limits imposed by planning laws on the use of the land
- » services that are or may be connected to the property
- » the presence of asbestos within buildings or improvements on the property.

You are encouraged to make your own inquiries about these matters before signing a contract. You may not be able to terminate the contract if these matters are discovered after you sign.

Part 1 – Seller and property details

Seller	Julie Ann Franich
Property address (referred to as the “property” in this statement)	7 Surch Ct Southport, Queensland, 4215
Lot on plan description	Lot 39, Plan RP212617, Title Reference 17039184

Community titles scheme
or BUGTA scheme:

Is the property part of a community titles scheme or a BUGTA scheme:

☐ **Yes**

*If **Yes**, refer to Part 6 of this statement
for additional information*

☒ **No**

*If **No**, please disregard Part 6 of this statement
as it does not need to be completed*

Part 2 – Title details, encumbrances and residential tenancy or rooming accommodation agreement

Title details	The seller gives or has given the buyer the following—
	A title search for the property issued under the <i>Land Title Act 1994</i> showing interests registered under that Act for the property. <input checked="" type="checkbox"/> Yes
	A copy of the plan of survey registered for the property. <input checked="" type="checkbox"/> Yes

Registered encumbrances	<p>Registered encumbrances, if any, are recorded on the title search, and may affect your use of the property. Examples include easements, statutory covenants, leases and mortgages.</p> <p>You should seek legal advice about your rights and obligations before signing the contract.</p>
Unregistered encumbrances (excluding statutory encumbrances)	<p>There are encumbrances not registered on the title that will continue to affect the property after settlement. <input type="checkbox"/> Yes <input checked="" type="checkbox"/> No</p> <p>Note—If the property is part of a community titles scheme or a BUGTA scheme it may be subject to and have the benefit of statutory easements that are NOT required to be disclosed.</p> <p>Unregistered lease (if applicable)</p> <p>If the unregistered encumbrance is an unregistered lease, the details of the agreement are as follows:</p> <p>» the start and end day of the term of the lease: <input type="text"/></p> <p>» the amount of rent and bond payable: <input type="text"/></p> <p>» whether the lease has an option to renew: <input type="text"/></p> <p>Other unregistered agreement in writing (if applicable)</p> <p>If the unregistered encumbrance is created by an agreement in writing, and is not an unregistered lease, a copy of the agreement is given, together with relevant plans, if any. <input type="checkbox"/> Yes</p> <p>Unregistered oral agreement (if applicable)</p> <p>If the unregistered encumbrance is created by an oral agreement, and is not an unregistered lease, the details of the agreement are as follows:</p> <div style="border: 1px solid black; height: 100px; width: 100%;"></div>
Statutory encumbrances	<p>There are statutory encumbrances that affect the property. <input checked="" type="checkbox"/> Yes <input type="checkbox"/> No</p> <p><i>If Yes, the details of any statutory encumbrances are as follows:</i></p> <div style="border: 1px solid black; padding: 10px; min-height: 100px;"> <p>Encumbrances discovered in the Dial Before you Dig Infrastructure report are a water hydrant and sewer manhole located and the front of the lot with a sewerage pip running under the lot and a water connection to the side of the lot as seen on page 30. Telstra cables connect to the lot as shown on page 45.</p> </div>
Residential tenancy or rooming accommodation agreement	<p>The property has been subject to a residential tenancy agreement or a rooming accommodation agreement under the <i>Residential Tenancies and Rooming Accommodation Act 2008</i> during the last 12 months. <input type="checkbox"/> Yes <input checked="" type="checkbox"/> No</p> <p>If Yes, when was the rent for the premises or each of the residents' rooms last increased? (<i>Insert date of the most recent rent increase for the premises or rooms</i>) <input type="text"/></p> <p>Note—Under the <i>Residential Tenancies and Rooming Accommodation Act 2008</i> the rent for a residential premises may not be increased earlier than 12 months after the last rent increase for the premises.</p> <p>As the owner of the property, you may need to provide evidence of the day of the last rent increase. You should ask the seller to provide this evidence to you prior to settlement.</p>

Part 3 – Land use, planning and environment

WARNING TO BUYER – You may not have any rights if the current or proposed use of the property is not lawful under the local planning scheme. You can obtain further information about any planning and development restrictions applicable to the lot, including in relation to short-term letting, from the relevant local government.

Zoning	<p>The zoning of the property is <i>(Insert zoning under the planning scheme, the Economic Development Act 2012; the Integrated Resort Development Act 1987; the Mixed Use Development Act 199; the State Development and Public Works Organisation Act 1971 or the Sanctuary Cove Resort Act 1985, as applicable)</i>:</p> <div style="border: 1px solid black; padding: 2px;">Medium density residential</div>		
Transport proposals and resumptions	<p>The lot is affected by a notice issued by a Commonwealth, State or local government entity and given to the seller about a transport infrastructure proposal* to: locate transport infrastructure on the property; or alter the dimensions of the property. <input type="checkbox"/> Yes <input checked="" type="checkbox"/> No</p> <p>The lot is affected by a notice of intention to resume the property or any part of the property. <input type="checkbox"/> Yes <input checked="" type="checkbox"/> No</p> <p><i>If Yes, a copy of the notice, order, proposal or correspondence must be given by the seller.</i></p>		
Contamination and environmental protection	<p>The property is recorded on the Environmental Management Register or the Contaminated Land Register under the <i>Environmental Protection Act 1994</i>. <input type="checkbox"/> Yes <input checked="" type="checkbox"/> No</p> <p>The following notices are, or have been, given:</p> <p>A notice under section 408(2) of the <i>Environmental Protection Act 1994</i> (for example, land is contaminated, show cause notice, requirement for site investigation, clean up notice or site management plan). <input type="checkbox"/> Yes <input checked="" type="checkbox"/> No</p> <p>A notice under section 369C(2) of the <i>Environmental Protection Act 1994</i> (the property is a place or business to which an environmental enforcement order applies). <input type="checkbox"/> Yes <input checked="" type="checkbox"/> No</p> <p>A notice under section 347(2) of the <i>Environmental Protection Act 1994</i> (the property is a place or business to which a prescribed transitional environmental program applies). <input type="checkbox"/> Yes <input checked="" type="checkbox"/> No</p>		
Trees	<p>There is a tree order or application under the <i>Neighbourhood Disputes (Dividing Fences and Trees) Act 2011</i> affecting the property. <input type="checkbox"/> Yes <input checked="" type="checkbox"/> No</p> <p><i>If Yes, a copy of the order or application must be given by the seller.</i></p>		
Heritage	<p>The property is affected by the <i>Queensland Heritage Act 1992</i> or is included in the World Heritage List under the <i>Environment Protection and Biodiversity Conservation Act 1999</i> (Cwlth). <input type="checkbox"/> Yes <input checked="" type="checkbox"/> No</p>		
Flooding	<p>Information about whether the property is affected by flooding or another natural hazard or within a natural hazard overlay can be obtained from the relevant local government and you should make your own enquires. Flood information for the property may also be available at the FloodCheck Queensland portal or the Australian Flood Risk Information portal.</p>		
Vegetation, habitats and protected plants	<p>Information about vegetation clearing, koala habitats and other restrictions on development of the land that may apply can be obtained from the relevant State government agency.</p>		

Part 4 – Buildings and structures

WARNING TO BUYER – The seller does not warrant the structural soundness of the buildings or improvements on the property, or that the buildings on the property have the required approval, or that there is no pest infestation affecting the property. You should engage a licensed building inspector or an appropriately qualified engineer, builder or pest inspector to inspect the property and provide a report and also undertake searches to determine whether buildings and improvements on the property have the required approvals.

Swimming pool	There is a relevant pool for the property.	<input checked="" type="checkbox"/> Yes	<input type="checkbox"/> No
	If a community titles scheme or a BUGTA scheme – a shared pool is located in the scheme.	<input type="checkbox"/> Yes	<input checked="" type="checkbox"/> No
	Pool compliance certificate is given.	<input checked="" type="checkbox"/> Yes	<input type="checkbox"/> No
	OR Notice of no pool safety certificate is given.	<input type="checkbox"/> Yes	<input type="checkbox"/> No
Unlicensed building work under owner builder permit	Building work was carried out on the property under an owner builder permit in the last 6 years.	<input type="checkbox"/> Yes	<input checked="" type="checkbox"/> No
	<i>A notice under section 47 of the Queensland Building and Construction Commission Act 1991 must be given by the seller and you may be required to sign the notice and return it to the seller prior to signing the contract.</i>		
Notices and orders	There is an unsatisfied show cause notice or enforcement notice under the <i>Building Act 1975</i> , section 246AG, 247 or 248 or under the <i>Planning Act 2016</i> , section 167 or 168.	<input type="checkbox"/> Yes	<input checked="" type="checkbox"/> No
	The seller has been given a notice or order, that remains in effect, from a local, State or Commonwealth government, a court or tribunal, or other competent authority, requiring work to be done or money to be spent in relation to the property.	<input type="checkbox"/> Yes	<input checked="" type="checkbox"/> No
	<i>If Yes, a copy of the notice or order must be given by the seller.</i>		
Building Energy Efficiency Certificate	If the property is a commercial office building of more than 1,000m ² , a Building Energy Efficiency Certificate is available on the Building Energy Efficiency Register.		
Asbestos	The seller does not warrant whether asbestos is present within buildings or improvements on the property. Buildings or improvements built before 1990 may contain asbestos. Asbestos containing materials (ACM) may have been used up until the early 2000s. Asbestos or ACM may become dangerous when damaged, disturbed, or deteriorating. Information about asbestos is available at the Queensland Government Asbestos Website (asbestos.qld.gov.au) including common locations of asbestos and other practical guidance for homeowners.		

Part 5 – Rates and services

WARNING TO BUYER – The amount of charges imposed on you may be different to the amount imposed on the seller.

Rates	Whichever of the following applies—
	The total amount payable* for all rates and charges (without any discount) for the property as stated in the most recent rate notice is:
	Amount: <input type="text" value="\$ 1,371.06"/> Date Range: <input type="text" value="1 Jul - 31 Dec 2025"/>
	OR
	The property is currently a rates exempt lot.** <input type="checkbox"/>
	OR
	The property is not rates exempt but no separate assessment of rates <input type="checkbox"/> is issued by a local government for the property.

*Concessions: A local government may grant a concession for rates. The concession will not pass to you as buyer unless you meet the criteria in section 120 of the *Local Government Regulation 2012* or section 112 of the *City of Brisbane Regulation 2012*.

** An exemption for rates applies to particular entities. The exemption will not pass to you as buyer unless you meet the criteria in section 93 of the *Local Government Act 2009* or section 95 of the *City of Brisbane Act 2010*.

Water	Whichever of the following applies—
	The total amount payable as charges for water services for the property as indicated in the most recent water services notice* is:
	Amount: <input type="text" value="\$ 533.60"/> Date Range: <input type="text" value="6 Aug - 31 Oct 2025"/>
	OR
	There is no separate water services notice issued for the lot; however, an estimate of the total amount payable for water services is:
	Amount: <input type="text"/> Date Range: <input type="text"/>

* A water services notices means a notice of water charges issued by a water service provider under the *Water Supply (Safety and Reliability) Act 2008*.

Part 6 – Community titles schemes and BUGTA schemes

(If the property is part of a community titles scheme or a BUGTA scheme this Part must be completed)

WARNING TO BUYER – If the property is part of a community titles scheme or a BUGTA scheme and you purchase the property, you will become a member of the body corporate for the scheme with the right to participate in significant decisions about the scheme and you will be required to pay contributions towards the body corporate's expenses in managing the scheme. You will also be required to comply with the by-laws. By-laws will regulate your use of common property and the lot.

For more information about living in a body corporate and your rights and obligations, contact the Office of the Commissioner for Body Corporate and Community Management.

Body Corporate and Community Management Act 1997	<p>The property is included in a community titles scheme. <input type="checkbox"/> Yes <input checked="" type="checkbox"/> No</p> <p><i>(If Yes, complete the information below)</i></p>
Community Management Statement	<p>A copy of the most recent community management statement for the scheme as recorded under the <i>Land Title Act 1994</i> or another Act is given to the buyer. <input type="checkbox"/> Yes</p> <p>Note—If the property is part of a community titles scheme, the community management statement for the scheme contains important information about the rights and obligations of owners of lots in the scheme including matters such as lot entitlements, by-laws and exclusive use areas.</p>
Body Corporate Certificate	<p>A copy of a body corporate certificate for the lot under the <i>Body Corporate and Community Management Act 1997</i>, section 205(4) is given to the buyer. <input type="checkbox"/> Yes <input checked="" type="checkbox"/> No</p> <p><i>If No</i>— An explanatory statement is given to the buyer that states: <input type="checkbox"/> Yes</p> <ul style="list-style-type: none"> » a copy of a body corporate certificate for the lot is not attached; and » the reasons under section 6 of the <i>Property Law Regulation 2024</i> why the seller has not been able to obtain a copy of the body corporate certificate for the lot.
Statutory Warranties	<p>Statutory Warranties—If you enter into a contract, you will have implied warranties under the <i>Body Corporate and Community Management Act 1997</i> relating to matters such as latent or patent defects in common property or body corporate assets; any actual, expected or contingent financial liabilities that are not part of the normal operating costs; and any circumstances in relation to the affairs of the body corporate that will materially prejudice you as owner of the property. There will be further disclosure about warranties in the contract.</p>

Building Units and Group Titles Act 1980	<p>The property is included in a BUGTA scheme <input type="checkbox"/> Yes <input checked="" type="checkbox"/> No</p> <p><i>(If Yes, complete the information below)</i></p>
Body Corporate Certificate	<p>A copy of a body corporate certificate for the lot under the <i>Building Units and Group Titles Act 1980</i>, section 40AA(1) is given to the buyer. <input type="checkbox"/> Yes <input type="checkbox"/> No</p> <p><i>If No</i>— An explanatory statement is given to the buyer that states: <input type="checkbox"/> Yes</p> <ul style="list-style-type: none"> » a copy of a body corporate certificate for the lot is not attached; and » the reasons under section 7 of the <i>Property Law Regulation 2024</i> why the seller has not been able to obtain a copy of the body corporate certificate for the lot. <p>Note—If the property is part of a BUGTA scheme, you will be subject to by-laws approved by the body corporate and other by-laws that regulate your use of the property and common property.</p>

Signatures – SELLER



as solicitor
on behalf of the seller

Signature of seller

Signature of seller

Julie Ann Franich

Name of seller

Name of seller

14/1/2026

Date

Date

Signatures – BUYER

By signing this disclosure statement the buyer acknowledges receipt of this disclosure statement before entering into a contract with the seller for the sale of the lot.

Signature of buyer

Signature of buyer

Name of buyer

Name of buyer

Date

Date



Current Title Search

Queensland Titles Registry Pty Ltd
ABN 23 648 568 101

Title Reference:	17039184	Search Date:	22/12/2025 10:20
Date Title Created:	08/07/1987	Request No:	54553484
Previous Title:	14995159		

ESTATE AND LAND

Estate in Fee Simple

LOT 39 REGISTERED PLAN 212617
Local Government: GOLD COAST

REGISTERED OWNER

Dealing No: 705457166 08/03/2002

JULIE ANN FRANICH

EASEMENTS, ENCUMBRANCES AND INTERESTS

1. Rights and interests reserved to the Crown by
Deed of Grant No. 11054166 (POR 47)
2. MORTGAGE No 713493952 01/10/2010 at 08:55
WESTPAC BANKING CORPORATION A.B.N. 33 007 457 141

ADMINISTRATIVE ADVICES

NIL

UNREGISTERED DEALINGS

NIL

Caution - Charges do not necessarily appear in order of priority

** End of Current Title Search **

WARNING - FOLDING OR MUTILATING WILL LEAD TO REJECTION - PLAN MAY BE ROLLED

212617

PLAN MUST BE DRAWN WITHIN BLUE LINES

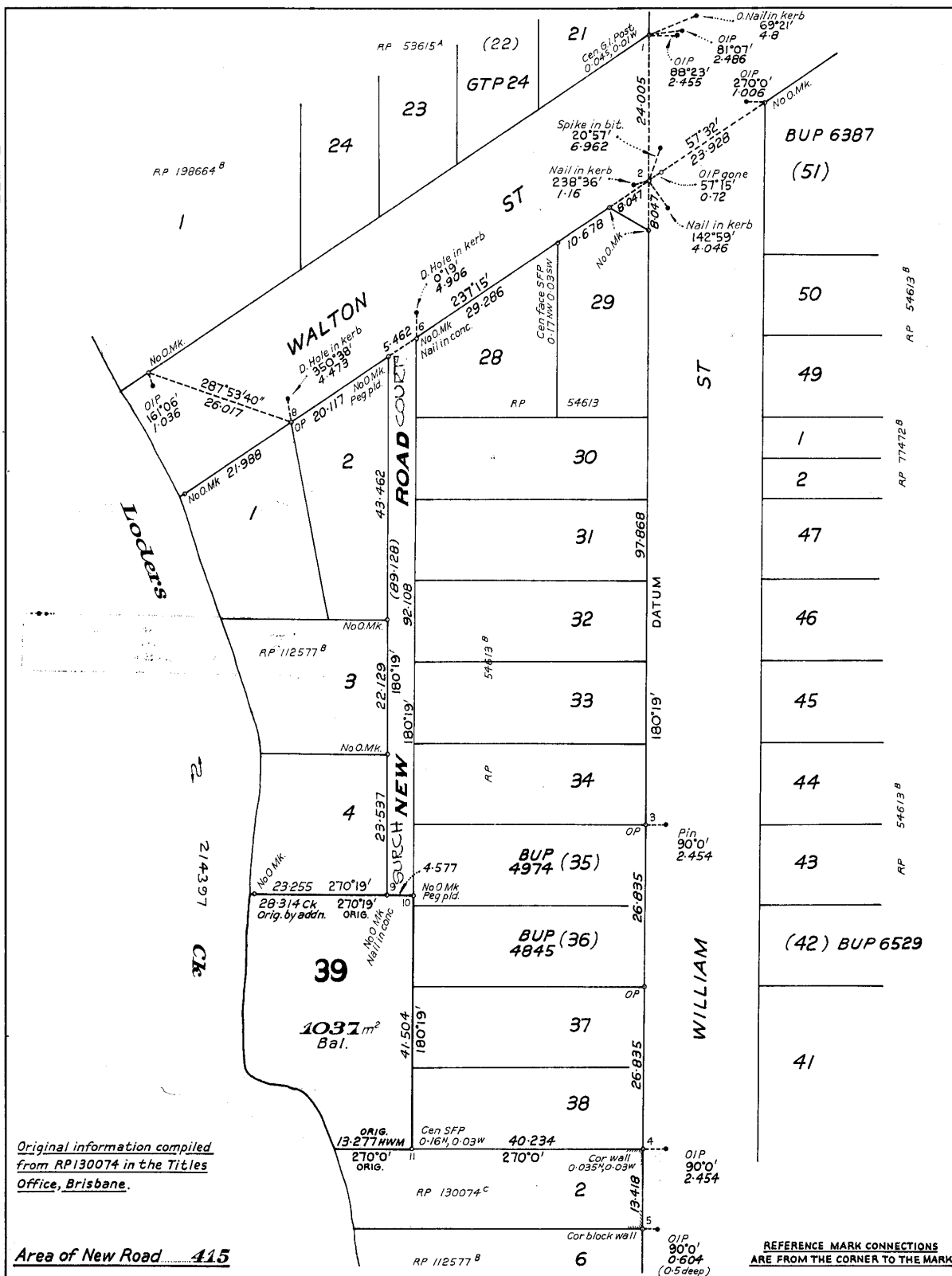

212617

PLAN MUST BE DRAWN WITHIN BLUE LINES

212617

No. FIELD NOTES LODGED		PLAN OF		Lot 39		ORIG. PORTION 41	
ORIGINAL GRANT		Cancelling Lot 1 on RP130074C				TOWN	
92406						PARISH NERANG	
						COUNTY Ward	
MAP REF. Gold Coast Sht. 3	PROCLAIMED SURVEY AREA	SURVEYED BY KARHULA BROOKER PIKE PTY LTD 2/1/3/1/87	MERIDIAN	SCALE 1:600	REGISTERED PLAN 212617		

RA 3-2351/40

CROWN COPYRIGHT RESERVED, REGISTRAR OF TITLES, QUEENSLAND

CISP M.F.

CISP

212618

FOR TITLES OFFICE USE ONLY

Previous Title
C.T. 4995-153 Lot 1 130074C
Easement App R/P 130074 (DE 55037) absorbed in new read

Survey was performed
Surveyor Regulation 19
187
The
Common
of
★ Signature of

 _____ Director
 _____ Director/
 ★ Signature of Licensed Surveyor

Date 5-3-87

Dated this Thirteenth day of May, 1987

(Names in full)

Signature of Proprietor / s J. Sawma R. Dawson

**For Additional Plan &
Document Notings
Refer to CISP**

[illegible]

Lodged by

RAY McCARTHY
LEGAL SERVICES

LEGAL SERVICES
KENNETH STEWART AND CO.

Particulars entered in
Register Book

Vol. 4995 Folio 159

Map Ref. Gold Coast, Sheet 3

at 11:17 *[Signature]*

3 JUL 1987

REGISTRAR OF TITLES

Fees Payable

Postal fee and Postage

98 - Lodat Exam & Ass

Lodgt. Exam. & Ass.

Entd. on Docs.

New Title

Entd. on Deeds

Photo Fee

Total

Short Fees Paid

Received
Registrar of Titles

Journal No.

Receipt No.

PLAN - 212617

A pool safety certificate is required in Queensland when selling or leasing a property with a regulated pool.
This form is to be used for the purposes of sections 246AA and 246AK of the *Building Act 1975*.

1. Pool safety certificate number

Identification number: PSC0279746

2. Location of the swimming pool

Property details are usually shown on the title documents and rates notices

Street address:

7 SURCH CT

SOUTHPORT QLD

Postcode

4

2

1

5

Lot and plan details:

39/RP/212617

Local government area:

GOLD COAST CITY

3. Exemptions or alternative solutions for the swimming pool (if applicable)

If an exemption or alternative solution is applicable to the swimming pool please state this. This will help provide pool owners with a concise and practical explanation of the exemption or alternative solution. It will also help to ensure the ongoing use of the pool and any future modifications do not compromise compliance with the pool safety standard.

No disability exemption applies; No impracticality exemption applies

No alternative solution applies

4. Pool properties

Shared pool

☐

Non-shared pool

☒

Number of pools

1

5. Pool safety certificate validity

Effective date:

0

2

/

0

1

/

2

0

2

6

Expiry date:

0

2

/

0

1

/

2

0

2

8

6. Certification

I certify that I have inspected the swimming pool and I am reasonably satisfied that, under the *Building Act 1975*, the pool is a complying pool.

Name:

WILLIAM RAYMOND CAMPBELL

Pool safety inspector
licence number:

PS100654

Signature:

*William Campbell***Other important information that could help save a young child's life**

It is the pool owner's responsibility to ensure that the pool (including the barriers for the pool) is properly maintained at all times to comply with the pool safety standard under the *Building Act 1975*. High penalties apply for non-compliance. Parents should also consider beginning swimming lessons for their young children from an early age. Please visit

<https://www.qbcc.qld.gov.au/your-property/swimming-pools/pool-safety-standard> for further information about swimming pool safety. This pool safety certificate does not certify that a building development approval has been given for the pool or the barriers for the pool. You can contact your local government to ensure this approval is in place.

Privacy statement

The Queensland Building and Construction Commission is collecting personal information as required under the *Building Act 1975*. This information may be stored by the QBCC, and will be used for administration, compliance, statistical research and evaluation of pool safety laws. Your personal information will be disclosed to other government agencies, local government authorities and third parties for purposes relating to administering and monitoring compliance with the Building Act 1975. Personal information will otherwise only be disclosed to third parties with your consent or unless authorised or required by law.

RTI: The information collected on this form will be retained as required by the *Public Records Act 2002* and other relevant Acts and regulations, and is subject to the Right to Information regime established by the *Right to Information Act 2009*.

This is a public document and the information in this form will be made available to the public.

[Review responses online](#) ↗



Received 4 of 4 responses
All responses received

7 Surch Ct, Southport QLD 4215

Job dates
22/12/2025 → 22/12/2026

These plans expire on
19 Jan 2026

Lodged by
Jared Zak

Authority	Status	Page
✉ BYDA Confirmation		2
🏠 APA Group Gas Networks (90073)	Received	4
🏠 City of Gold Coast	Received	15
🏠 NBN Co Qld	Received	18
🏠 Telstra QLD South East	Received	29

Contact Details

Contact	Contact number	Company	Enquirer ID
Jared Zak	0449 773 105	Dott & Crossitt	3756031
Email		Address	
team.jared@dottandcrossitt.com.au		1-2/2-4 New Street Nerang QLD 4211	

Job Site and Enquiry Details

WARNING: The map below only displays the location of the proposed job site and does not display any asset owners' pipe or cables. The area highlighted has been used only to identify the participating asset owners, who will send information to you directly.

Enquiry date	Start date	End date	On behalf of	Job purpose	Locations	Onsite activities
22/12/2025	22/12/2025	22/12/2026	Private	Design	Private	Conveyancing



Check that the location of the job site is correct. If not, you must submit a new enquiry.

If the scope of works change or plan validity dates expire, you must submit a new enquiry.

Do NOT dig without plans. Safe excavation is your responsibility. If you don't understand the plans or how to proceed safely, please contact the relevant asset owners.

User Reference	Address	Notes/description
7 Surch Ct	7 Surch Ct Southport QLD 4215	-

Your Responsibility and Duty of Care

- Lodging an enquiry does not authorise project commencement.** Before starting work, you must obtain all necessary information from all affected asset owners.
- If you don't receive plans within 2 business days, contact the asset owner & quote their sequence number.
- Always follow the 5Ps of Safe Excavation (page 2), and locate assets before commencing work.
- Ensure you comply with State legislative requirements for Duty of Care and safe digging.
- If you damage an underground asset, you MUST advise the asset owner immediately.
- By using the BYDA service, you agree to the [Privacy Policy](#) and [Term of Use](#).
- For more information on safe digging practices, visit www.byda.com.au

Asset Owner Details

Below is a list of asset owners with underground infrastructure in and around your job site. It is your responsibility to identify the presence of these assets. Plans issued by Members are indicative only unless specified otherwise. Note: not all asset owners are registered with BYDA. You must contact asset owners not listed here directly.

Referral ID (Seq. no)	Authority Name	Phone	Status
265982515	APA Group Gas Networks (90073)	1800 085 628	NOTIFIED
265982514	City of Gold Coast	1300 465 326	NOTIFIED
265982513	NBN Co Qld	1800 687 626	NOTIFIED
265982516	Telstra QLD South East	1800 653 935	NOTIFIED

END OF UTILITIES LIST



Plan

Plan your job. Use the BYDA service at least one day before your job is due to begin, and ensure you have the correct plans and information required to carry out a safe project.



Prepare

Prepare by communicating with asset owners if you need assistance. Look for clues onsite. Engage a skilled Locator.



Pothole

Potholing is physically sighting the asset by hand digging or hydro vacuum extraction.

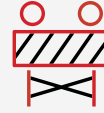

Protect

Protecting and supporting the exposed infrastructure is the responsibility of the excavator. Always erect safety barriers in areas of risk and enforce exclusion zones.



Proceed

Only proceed with your excavation work after planning, preparing, potholing (unless prohibited), and having protective measures in place.

Engage a skilled Locator

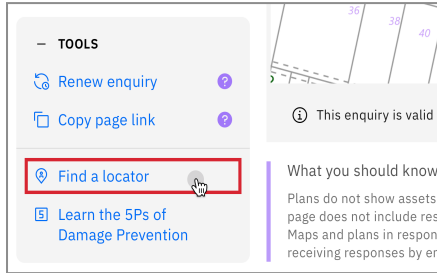

When you lodge an enquiry you will see skilled Locators to contact

Visit the Certified Locator website directly and search for a locator near you

certloc.com.au/locators

Get FREE Quotes for Contractors & Equipment Fast



GET QUOTE

Use isseekplant's FREE marketplace to get quotes for the equipment or services you need on your project. Compare quotes from trusted local contractors and get your project done on time and in budget.

1. Fill out your job details in our FREE quick quote form.
2. We send the request to trusted local contractors.
3. The local contractors will contact you directly with quotes

Use isseekplant to find trusted contractors near you today, visit:
blog.isseekplant.com.au/byda-isp-get-quotes

Book a FREE BYDA Session



BOOK NOW

BYDA offers free training sessions to suit you and your organisation's needs covering safe work practices when working near essential infrastructure assets. The free sessions are offered in two different formats - online and face-to-face.

To book a session, visit:
byda.com.au/contact/education-awareness-enquiry-form

APA Group Gas Networks (90073)

Referral
265982515

Member Phone
1800 085 628

Responses from this member

Response received Mon 22 Dec 2025 11.33am

File name	Page
Response Body	5
265982515.pdf	6

PLEASE NOTE: This is an automated response. Please **DO NOT REPLY to this email.** If you require further information in relation to this Before You Dig response, please contact

BYDA_APA@apa.com.au

Enquiry Details:

Impact	not affected
Sequence Number	265982515
Enquirer Id	3756031
Activity	Conveyancing
Job Number	51992054
User Reference	7 Surch Ct
Message	

Site Details:

Address	7 Surch Ct Southport QLD 4215
---------	-------------------------------------

Enquirers Details:

Contact	Jared Zak
Company	Dott & Crossitt
Email	form2@dottandcrossitt.com.au
Phone	+61449773105
Address	1-2/2-4 New Street Nerang QLD 4211

APA Group

APA

Australia's energy
infrastructure partner



Before You Dig Australia

Classification: Networks

Enquiry date	22/12/2025
Sequence number	265982515
Work site address	7 Surch Ct Southport QLD 4215



Enquiry Date: 22/12/2025
Enquirer: Jared Zak
Sequence Number: 265982515
Work Site Address: 7 Surch Ct
Southport
QLD 4215

Thank you for your Before You Dig enquiry regarding the location of gas assets.

We confirm there are NO Gas Assets located in close vicinity of the above location.

Caution: Damage to gas assets may result in explosion, fire and personal injury.

Please ensure you read and comply with all the relevant information contained in this response to your BYDA enquiry.

Before You Dig Checklist



1. Plan

- Review maps provided with this BYDA response and confirm the location of your work site is correct.



2. Prepare

- Electronically locate gas assets and mark locations.
- Note: Look for visible evidence of gas assets at the worksite which may not be shown on plans.



3. Pothole

- Not applicable where no gas assets present.



4. Protect

- Not applicable where no gas assets present.



5. Proceed

- Only proceed with your work once you are confident no gas assets are located in vicinity to your work location.
 - APA BYDA response (including maps) are on site for reference at all times, and less than 30 days old.
-

Contacts

Contacts APA Group	
Enquiry	Contact Numbers
General enquiries or feedback regarding this information or gas assets.	APA – Before You Dig Officer Phone: 1800 085 628 Email: BYDA_APA@apa.com.au
Gas Emergencies	Phone: 1800 GAS LEAK (1800 427 532)

Site Watch

Site Watch is where an APA field officer attends your work site to monitor and ensure controls are in place to protect critical gas assets from damage during work.

The following rates* apply for this service (1 hour minimum charge):

Item	Rate (excl. gst)
Site Watch – Business Hours	\$143.42 per hour
Site Watch – After Hours	\$175.06 per hour
Cancellation Fee	\$286.84
<i>Fee applies where cancelations received after 12pm (midday), 1 business day prior to the booking</i>	

Contact APA – Before You Dig officer for state specific hours of business.

**The specified rates do not apply to Origin Energy LPG assets. All charges and invoicing related to these assets will be administered directly by Origin Energy. For further information contact Origin Energy.*

Site 7 Surch Ct
Address: Southport
QLD 4215

Sequence 265982515
Number:

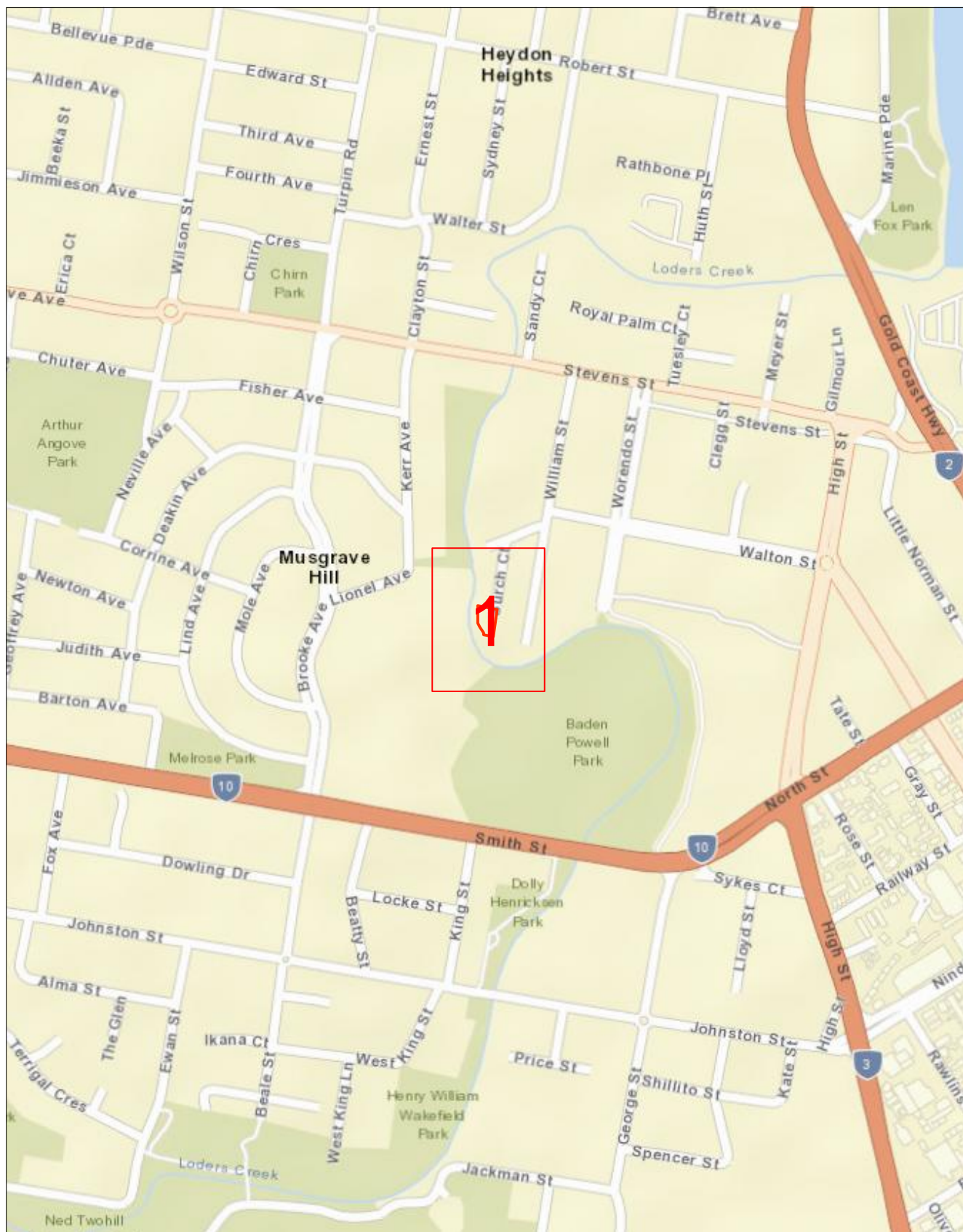

Scale 1: 6000

Map Sources: Esri, Garmin, HERE, FAO, NOAA, USGS,
© OpenStreetMap contributors, and the GIS User Community



Enquiry Area



Map Key Area



Site 7 Surch Ct
Address: Southport
QLD 4215

Sequence 265982515
Number:



Scale 1: 700

Map Sources: Esri, Garmin, HERE, FAO, NOAA, USGS,
© OpenStreetMap contributors, and the GIS User Community



Enquiry Area



Map Key Area



Legend

PIPE LEGEND: GAS TYPE AND PRESSURE

	Low pressure	Medium pressure	High pressure	Transmission
Natural gas				
Natural gas – proposed				
LPG (yellow dash)	not applicable			not applicable
Hydrogen blended (aqua dash)	not applicable			not applicable

PIPE LEGEND: SPECIAL DESIGNATION

	Low pressure	Medium pressure	High pressure	Transmission
Critical main (yellow highlight)				
Casing (grey highlight)				not applicable

These designations typically apply to any pipe type and pressure

PIPE LEGEND: OTHER STATUS

Abandoned pipe	
Idle or inactive pipe	

ABBREVIATION

BoK	Back of kerb	FoK	Front of kerb
C	Depth of cover	NTI	Not tied in
CP	Cathodic protection		

OBJECT SYMBOLS

Valve		CP test station		Syphon	
Buried valve		CP anode		Marker	
Regulator station		CP bond wire		Part service ^A	
Gas connected property		CP rectifier terminal			

^AA live gas service terminated underground within the property boundary, available for future extension to the gas meter.

PIPE CODE AND MATERIAL

P*	Polyethylene (PE)	CU	Copper
P3	Polyvinyl chloride (PVC)	N2	Nylon
S*	Steel	W2	Wrought galv iron
C*	Cast iron	W3	PE coat wrought galv iron

INTERPRETATION EXAMPLE

	High pressure, 40 mm polyethylene in an 80 mm cast iron casing
	Medium pressure, 63 mm steel

Pipe diameter in millimetres is shown before pipe code.
40P6 = 40 mm nominal diameter

This map was created in colour and should be printed in colour

Important information

- Refer to requirements relating to construction, excavation and other work activities in the **APA Guidelines for Works Near Existing Gas Assets** document with this BYDA response.
- BYDA enquiries are valid for 30 days. If your works commence after 30 days from the date of this response a new enquiry is required to validate location information.
- **For some BYDA enquiries, you may receive two (2) responses from APA. Please read both responses carefully as they relate to different assets.**
- Gas (inlet) services connecting Gas Assets in the street to the gas meter on the property are not marked on the map. South Australia Only – if a meter box is installed on the property, a sketch of the gas service location may be found inside the gas meter box. APA does not guarantee the accuracy or completeness of these sketches.

Free Gas Pipeline Awareness Training and Information

PROFESSIONALS

APA offers online and in-person toolbox forums to support safe work near underground gas assets. Topics include distribution and transmission pipelines, the permit process, and gas emergencies, with content suited for companies of all sizes. A Continuing Professional Development certificate is available upon completion.

Scan the QR code to register for an online toolbox, or email damageprevention@apa.com.au to request an in-person presentation.

HOMEOWNERS

If you're working near your home's gas pipes stay safe and view APA's video guide '**Working Safely Near Gas Lines: A DIY Homeowner's Guide**' which offers simple tips to avoid damaging gas pipes.

Scan the QR code to view the video, or for more information email damageprevention@apa.com.au



Disclaimer and legal details

- This information is valid for 30 days from the date of this response.
- This information has been generated by an automated system based on the area highlighted in your BYDA request and has not been independently verified.
- Map location information is provided as AS5488-2022 Quality Level D, as such supplied location information is indicative only.
- Whilst APA has taken reasonable steps to ensure that the information supplied is accurate, the information is provided strictly on the condition that no assurance, representation, warranty or guarantee (express or implied) is given by APA in relation to the information (including without limitation quality, accuracy, reliability, completeness, currency, sustainability, or suitability for any particular purpose) except that the information has been disclosed in good faith.
- Any party who undertakes activities in the vicinity of APA operated assets has a legal duty of care that must be observed. This legal obligation requires all parties to adhere to a standard of reasonable care while performing any acts that could foreseeably harm these assets



Referral

265982514

Member Phone

1300 465 326

Responses from this member

Response received Mon 22 Dec 2025 11.33am

File name	Page
Response Body	16
ASSET 265982514.pdf	17

Attention: **Jared Zak**

Thank you for your Before You Dig (BYDA) enquiry.

Job Number: **51992054**

Sequence Number: **265982514**

Dig Site Location: **7 Surch Ct Southport QLD 4215**

According to our records, your enquiry with the following details **impacts our infrastructure**. Please ensure that you read the attached documents, it contains important information including essential steps that must be undertaken prior to commencing construction activities.

This enquiry is valid for **30 days** from the enquiry date.

If you require further information or assistance with interpretation of plans, please contact **City of Gold Coast** on **1300 465 326**.

This enquiry response, including any associated documentation, has been assessed and compiled from the information detailed within the BYDA enquiry outlined above. Please ensure that the BYDA enquiry details and this response accurately reflect your proposed works.

For more detailed information visit the [City of Gold Coast External Data Portal](#).



In an emergency contact City of Gold Coast on 1300 465 326

22/12/25 (valid for 30 days)

Plans generated by SmarterWX™ Automate

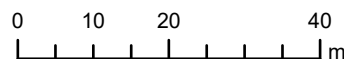

Scale 1:1,000

Referral265982513

Member Phone1800 687 626

Responses from this member

Response received Mon 22 Dec 2025 11.36am

File name	Page
Response Body	19
265982513_20251222_003546160463_1.pdf	20
4678_NBN_Dial_Before_You_Dig_Poster_20170517.pdf	23
Disclaimer_265982513_20251222_003546160463.pdf	25

Hi Jared Zak,

Please find attached the response to your DBYD referral for the address mentioned in the subject line. The location shown in our DBYD response is assumed based off the information you have provided. If the location shown is different to the location of the excavation then this response will consequently be rendered invalid.

Take the time to read the response carefully and note that this information is only valid for 28 days after the date of issue.

If you have any further enquiries, please do not hesitate to contact us.

Regards,
Network Services and Operations
NBN Co Limited
P: 1800626329
E: dbyd@nbnco.com.au
www.nbnco.com.au

Confidentiality and Privilege Notice

This e-mail is intended only to be read or used by the addressee. It is confidential and may contain legally privileged information. If you are not the addressee indicated in this message (or responsible for delivery of the message to such person), you may not copy or deliver this message to anyone, and you should destroy this message and kindly notify the sender by reply e-mail. Confidentiality and legal privilege are not waived or lost by reason of mistaken delivery to you. Any views expressed in this message are those of the individual sender, except where the sender specifically states them to be the views of NBN Co Limited

Please Do Not Reply To This Mail

To: Jared Zak
Phone: Not Supplied
Fax: Not Supplied
Email: form2@dottandcrossitt.com.au

Dial before you dig Job #:	51992054	
Sequence #	265982513	
Issue Date:	22/12/2025	
Location:	7 Surch Ct , Southport , QLD , 4215	

Indicative Plans are tiled below to demonstrate how to layout and read nbn asset plans



LEGEND



	Parcel and the location
	Pit with size "5"
	Power Pit with size "2E". Valid PIT Size: e.g. 2E, 5E, 6E, 8E, 9E, E, null.
	Manhole
	Pillar
	Cable count of trench is 2. One "Other size" PVC conduit (PO) owned by Telstra (-T-), between pits of sizes, "5" and "9" are 25.0m apart. One 40mm PVC conduit (P40) owned by NBN, between pits of sizes, "5" and "9" are 20.0m apart.
	2 Direct buried cables between pits of sizes, "5" and "9" are 10.0m apart.
	Trench containing any INSERVICE/CONSTRUCTED (Copper/RF/Fibre) cables.
	Trench containing only DESIGNED/PLANNED (Copper/RF/Fibre/Power) cables.
	Trench containing any INSERVICE/CONSTRUCTED (Power) cables.
	Road and the street name "Broadway ST"
Scale	0 20 40 60 Meters 1:2000 1 cm equals 20 m

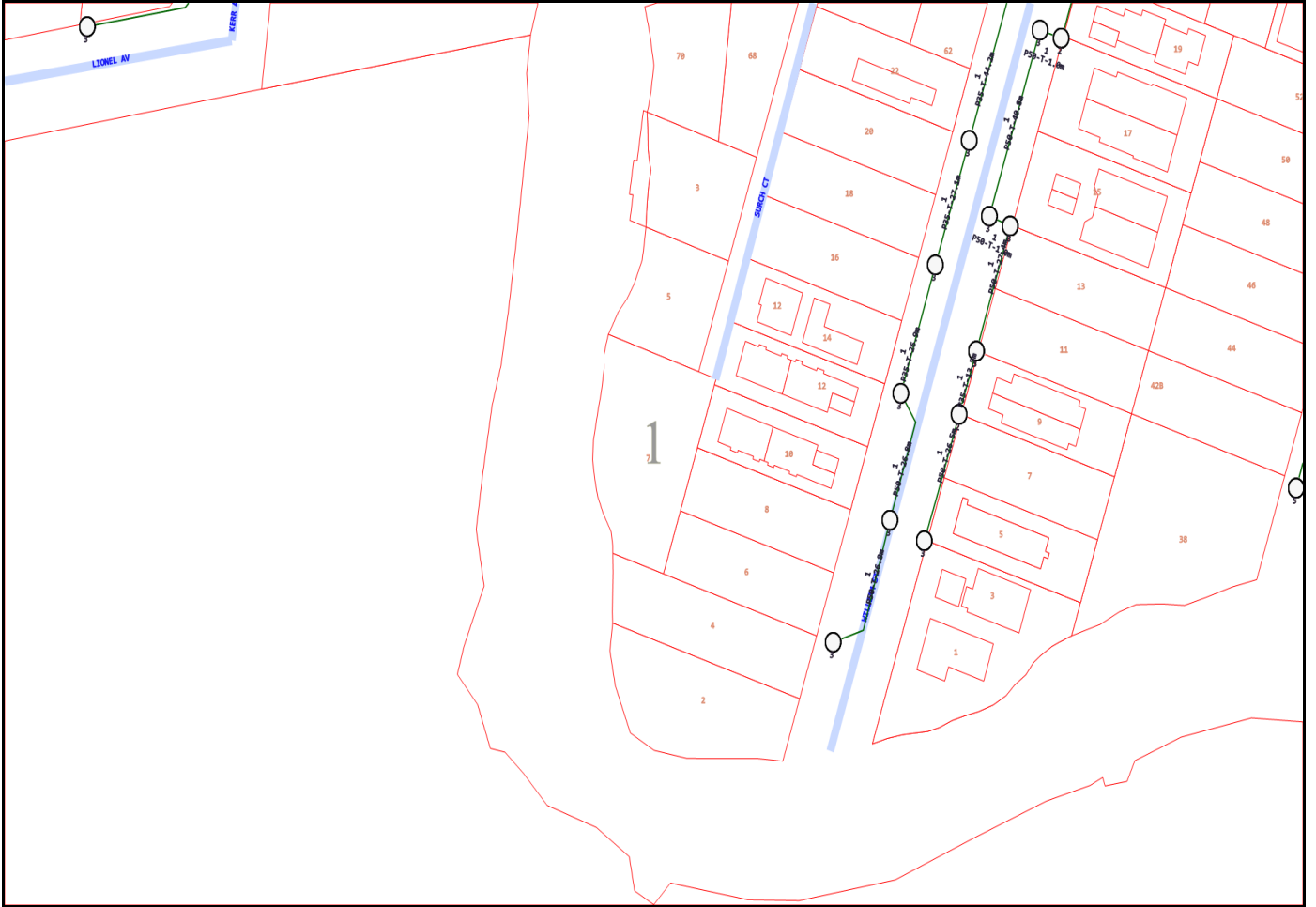

Emergency Contacts

You must immediately report any damage to the **nbn**[™] network that you are/become aware of. Notification may be by telephone - 1800 626 329.



Working near **nbn**TM cables

nbn has partnered with Dial Before You Dig to give you a single point of contact to get information about **nbn** underground services owned by **nbn** and other utility/service providers in your area including communications, electricity, gas and other services. Contact with underground power cables and gas services can result in serious injury to the worker, and damage and costly repairs. You must familiarise yourself with all of the Referral Conditions (meaning the referral conditions referred to in the DBYD Notice provided by **nbn**).

Practice safe work habits

Once the DBYD plans are reviewed, the Five P's of Excavation should be adopted in conjunction with your safe work practices (which must be compliant with the relevant state Electrical Safety Act and Safe Work Australia "Excavation Work Code of Practice", as a minimum) to ensure the risk of any contact with underground **nbn** assets are minimised.



Plan: Plan your job by ensuring the plans received are current and apply to the work to be performed. Also check for any visual cues that may indicate the presence of services not covered in the DBYD plans.



Prepare: Prepare for your job by engaging a DBYD Certified Plant Locator to help interpret plans and identify on-site assets. Contact **nbn** should you require further assistance.

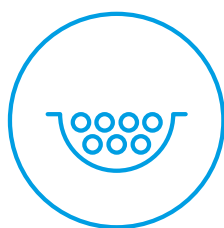

Pothole: Non-destructive potholing (i.e. hand digging or hydro excavation) should be used to positively locate **nbn** underground assets with minimal risk of contact and service damage.

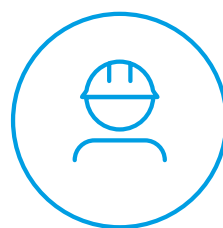

Protect: Protecting and supporting the exposed **nbn** underground asset is the responsibility of the worker. Exclusion zones for **nbn** assets are clearly stated in the plan and appropriate controls must be implemented to ensure that encroachment into the exclusion zone by machinery or activities with the potential to damage the asset is prevented.

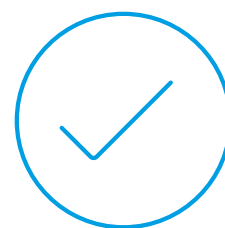

Proceed: Proceed only when the appropriate planning, preparation, potholing and protective measures are in place.

Working near **nbn**TM cables

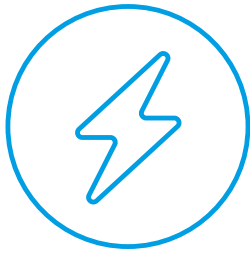

Identify all electrical hazards, assess the risks and establish control measures.

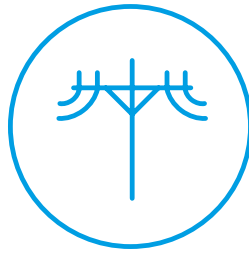

When using excavators and other machinery, also check the location of overhead power lines.

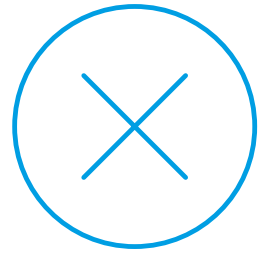

Workers and equipment must maintain safety exclusion zones around power lines.

Once all work is completed, the excavation should be re-instated with the same type of excavated material unless specified by **nbn**. Please note:

- Construction Partners of **nbn** may require additional controls to be in place when performing excavation activities.
- The information contained within this pamphlet must be used in conjunction with other material supplied as part of this request for information to adequately control the risk of potential asset damage.

Contact

All **nbn**TM network facility damages must be reported online [here](#).
For enquiries related to your DBYD request please call 1800 626 329.

Disclaimer

This brochure is a guide only. It does not address all the matters you need to consider when working near our cables. You must familiarise yourself with other material provided (including the Referral Conditions) and make your own inquiries as appropriate.

nbn will not be liable or responsible for any loss, damage or costs incurred as a result of reliance on this brochure.

This document is provided for information purposes only. This document is subject to the information classification set out on this page. If no information classification has been included, this document must be treated as UNCLASSIFIED, SENSITIVE and must not be disclosed other than with the consent of nbn co. The recipient (including third parties) must make and rely on their own inquiries as to the currency, accuracy and completeness of the information contained herein and must not use this document other than with the consent of nbn co. Copyright © 2021 nbn co limited. All rights reserved.



To: Jared Zak
Phone: Not Supplied
Fax: Not Supplied
Email: form2@dottandcrossitt.com.au

Before You Dig Australia Job #:	51992054	 BEFORE YOU DIG www.byda.com.au Zero Damage - Zero Harm
Sequence #	265982513	
Issue Date:	22/12/2025	
Location:	7 Surch Ct , Southport , QLD , 4215	

Information

The area of interest requested by you contains one or more assets.

nbn™ Assets	Search Results
Communications	Asset identified
Electricity	No assets

In this notice **nbn™ Facilities** means *underground fibre optic, telecommunications and/or power facilities, including but not limited to cables, owned and controlled by nbn™*

Location of nbn™ Underground Assets

We thank you for your enquiry. In relation to your enquiry at the above address:

- **nbn's** records indicate that there **ARE nbn™** Facilities in the vicinity of the location identified above ("Location").
- **nbn** indicative plan/s are attached with this notice ("Indicative Plans").
- The Indicative Plan/s show general depth and alignment information only and are not an exact, scale or accurate depiction of the location, depth and alignment of **nbn™** Facilities shown on the Plan/s.
- In particular, the fact that the Indicative Plans show that a facility is installed in a straight line, or at uniform depth along its length cannot be relied upon as evidence that the facility is, in fact, installed in a straight line or at uniform depth.
- You should read the Indicative Plans in conjunction with this notice and in particular, the notes below.
- You should note that, at the present time, the Indicative Plans are likely to be more accurate in showing location of fibre optics and telecommunications cables than power cables. There may be a variation between the line depicted on the Indicative Plans and the location of any power cables. As such, consistent with the notes below, particular care must be taken by you to make your own enquiries and investigations to precisely locate any power cables and manage the risk arising from such cables accordingly.
- The information contained in the Indicative Plan/s is valid for 28 days from the date of issue set out above. You are expected to make your own inquiries and perform your own investigations (including engaging appropriately qualified plant locators, e.g BYDA Certified Locators, at your cost to locate **nbn™** Facilities during any activities you carry out on site).

We thank you for your enquiry and appreciate your continued use of the Before You Dig Australia Service. For any enquiries related to moving assets or Planning and Design activities, please visit the **nbn Commercial Works** website to complete the online application form. If you are planning to excavate and require further information, please email dbyd@nbnc.com.au or call 1800 626 329.

Notes:

1. You are now aware that there are **nbn™** Facilities in the vicinity of the above property that could be damaged as a result activities carried out (or proposed to be carried out) by you in the vicinity of the Location.
2. You should have regard to section 474.6 and 474.7 of the *Criminal Code Act 1995* (CoA) which deals with the consequences of interfering or tampering with a telecommunications facility. Only persons authorised by **nbn** can interact with **nbn's** network facilities.
3. Any information provided is valid only for **28 days** from the date of issue set out above.

Referral Conditions

The following are conditions on which **nbn** provides you with the Indicative Plans. By accepting the plans, you are agreeing to these conditions. These conditions are in addition, and not in replacement of, any duties and obligations you have under applicable law.

1. **nbn** does not accept any responsibility for any inaccuracies of its plans including the Indicative Plans. You are expected to make your own inquiries and perform your own investigations (including engaging appropriately qualified plant locators, e.g BYDA Certified Locators, at your cost to locate **nbn™** Facilities during any activities you carry out on site).
2. You acknowledge that **nbn** has specifically notified you above that the Indicative Plans are likely to be more accurate in showing location of fibre optics and telecommunications cables than power cables. There may be a variation between the line depicted on the Indicative Plans and the location of any power cables.
3. You should not assume that **nbn™** Facilities follow straight lines or are installed at uniform depths

along their lengths, even if they are indicated on plans provided to you. Careful onsite investigations are essential to locate the exact position of cables.

4. In carrying out any works in the vicinity of **nbn**™ Facilities, you must maintain the following minimum clearances:
 - 300mm when laying assets inline, horizontally or vertically.
 - 500mm when operating vibrating equipment, for example: jackhammers or vibrating plates.
 - 1000mm when operating mechanical excavators.
 - Adherence to clearances as directed by other asset owner's instructions and take into account any uncertainty for power cables.
5. You are aware that there are inherent risks and dangers associated with carrying out work in the vicinity of underground facilities (such as **nbn**™ fibre optic, copper and coaxial cables, and power cable feed to **nbn**™ assets). Damage to underground electric cables may result in:
 - Injury from electric shock or severe burns, with the possibility of death.
 - Interruption of the electricity supply to wide areas of the city.
 - Damage to your excavating plant.
 - Responsibility for the cost of repairs.
6. You must take all reasonable precautions to avoid damaging **nbn**™ Facilities. These precautions may include but not limited to the following:
 - All excavation sites should be examined for underground cables by careful hand excavation. Cable cover slabs if present must not be disturbed. Hand excavation needs to be undertaken with extreme care to minimise the likelihood of damage to the cable, for example: the blades of hand equipment should be aligned parallel to the line of the cable rather than digging across the cable.
 - If any undisclosed underground cables are located, notify **nbn** immediately.
 - All personnel must be properly briefed, particularly those associated with the use of earth-moving equipment, trenching, boring and pneumatic equipment.
 - The safety of the public and other workers must be ensured.
 - All excavations must be undertaken in accordance with all relevant legislation and regulations.
7. You will be responsible for all damage to **nbn**™ Facilities that are connected whether directly, or indirectly with work you carry out (or work that is carried out for you or on your behalf) at the Location. This will include, without limitation, all losses expenses incurred by **nbn** as a result of any such damage.
8. You must immediately report any damage to the **nbn**™ network that you are/become aware of. Notification may be by telephone - 1800 626 329.
9. Except to the extent that liability may not be capable of lawful exclusion, **nbn** and its servants and agents and the related bodies corporate of **nbn** and their servants and agents shall be under no liability whatsoever to any person for any loss or damage (including indirect or consequential loss or damage) however caused (including, without limitation, breach of contract negligence and/or breach of statute) which may be suffered or incurred from or in connection with this information sheet or any plans (including Indicative Plans) attached hereto. Except as expressly provided to the contrary in this information sheet or the attached plans (including Indicative Plans), all terms, conditions, warranties, undertakings or representations (whether expressed or implied) are excluded to the fullest extent permitted by law.

All works undertaken shall be in accordance with all relevant legislations, acts and regulations applicable to the particular state or territory of the Location. The following table lists all relevant documents that shall be considered and adhered to.

State/Territory	Documents
National	Work Health and Safety Act 2011
	Work Health and Safety Regulations 2011
	Safe Work Australia - Working in the Vicinity of Overhead and Underground Electric Lines (Draft)

	Occupational Health and Safety Act 1991
NSW	Electricity Supply Act 1995
	Work Cover NSW - Work Near Underground Assets Guide
	Work Cover NSW - Excavation Work: Code of Practice
VIC	Electricity Safety Act 1998
	Electricity Safety (Network Asset) Regulations 1999
QLD	Electrical Safety Act 2002
	Code of Practice for Working Near Exposed Live Parts
SA	Electricity Act 1996
TAS	Tasmanian Electricity Supply Industry Act 1995
WA	Electricity Act 1945
	Electricity Regulations 1947
NT	Electricity Reform Act 2005
	Electricity Reform (Safety and Technical) Regulations 2005
ACT	Electricity Act 1971

Thank You,

nbn BYDA

Date: 22/12/2025

This document is provided for information purposes only. This document is subject to the information classification set out on this page. If no information classification has been included, this document must be treated as UNCLASSIFIED, SENSITIVE and must not be disclosed other than with the consent of nbn co. The recipient (including third parties) must make and rely on their own inquiries as to the currency, accuracy and completeness of the information contained herein and must not use this document other than with the consent of nbn co.

Copyright © 2021 nbn co Limited. All rights reserved.

Referral

265982516

Member Phone

1800 653 935

Responses from this member

Response received Mon 22 Dec 2025 11.36am

File name	Page
Response Body	30
265982516.pdf	32
AccreditedPlantLocators 2025-12-17b.pdf	34
Telstra Duty of Care v33.0a.pdf	35
Telstra Map Legend v4_0c.pdf	37



Attention: Jared Zak

Site Location: 7 Surch Ct, Southport, QLD 4215

Your Job Reference: 7 Surch Ct

Please do not reply to this email, this is an automated message -

Thank you for requesting Telstra information via Before You Dig Australia (BYDA). This response contains Telstra Information relating to your recent request.





 Accredited Plant Locator	General Contact Information including applications required to view Cable Plans - DWF & PDF
 Telstra Duty of Care v33.0a	Your responsibility and Legal requirements working near Telstra's Assets
 Telstra Map Legend v4_0c	Common Symbols on Cable Plans and Safe Clearance distances when working near Telstra Assets



Please note:

When working in the vicinity of telecommunications plant you have a 'Duty of Care' that must be observed.

Ensure you read all documents (attached) - they contain important information.

In particular please read and familiarise yourself with the Before you Dig Australia - BEST PRACTISE GUIDES and The five Ps of safe excavation <https://www.byda.com.au/before-you-dig/best-practice-guides/>, as these documents set out the essential steps that must be undertaken prior to commencing construction activities.

 Best practice guides and the five P's of safe excavation	These are the essential steps to be undertaken prior to commencing construction activities	Essential Steps : Link 5 P's: Link
	Telstra highly recommends using Certified Locators	CERTLOC : Link
 1800 653 935 Telstra Plan Services	Whenever in doubt please contact this number for Telstra BYDA map related enquiries email Telstra.Plans@team.telstra.com	Note: that Telstra plans are only valid for 60 days from the date of issue
 How to Report Damage to Telstra Equipment	If you think you have damaged Telstra Assets, please Report it ASAP.	Call: 13 22 03 Report Online: Link

	<p>It is a criminal offence under the 'Criminal code act 1995' to tamper or interfere with Telecommunications infrastructure. Telstra will take action to recover compensation for the damage caused to property and assets, and for interference with the operation of Telstra's networks and customer service.</p>
	<p>Telstra plans contain confidential information and are provided on the basis that they are used solely for identifying location or vicinity of Telstra's infrastructure to avoid damage to this infrastructure occurring as part of any digging or other excavation activity. You must not use Telstra's plans for any other purpose or in a way that will cause loss or damage. You must comply with any other terms of access to the data that have been provided by you by Telstra (including conditions of use or access).</p>

<p>WARNING: Telstra plans and location information conform to Quality Level 'D' of the Australian Standard AS 5488 - Classification of Subsurface Utility Information. As such, Telstra supplied location information is indicative only. Spatial accuracy is not applicable to Quality Level D. Refer to AS 5488 for further details. The exact position of Telstra assets can only be validated by physically exposing them. Telstra does not warrant or hold out that its plans are accurate and accepts no responsibility for any inaccuracy. Further on site investigation is required to validate the exact location of Telstra assets prior to commencing work. A Certified Locating Organisation is an essential part of the process to validate the exact location of Telstra assets and to ensure the assets are protected during construction works.</p> <p>See the Before You Dig Australia - BEST PRACTISE GUIDES and The five Ps of safe excavation https://www.byda.com.au/before-you-dig/best-practice-guides/.</p> <p>Please note that:</p> <ul style="list-style-type: none"> - it is a criminal offence under the <i>Criminal Code Act 1995</i> (Cth) to tamper or interfere with telecommunications infrastructure. - Telstra will take action to recover compensation for damage caused to property and assets, and for interference with the operation of Telstra's networks and customers' services. <p>Telstra's plans contain Telstra's confidential information and are provided on the basis that they are used solely for identifying the location or vicinity of Telstra's infrastructure to avoid damage to this infrastructure occurring as part of any digging or other excavation activity. You must not use Telstra's plans for any other purpose or in a way that will cause Telstra loss or damage and you must comply with any other terms of access to the data that have been provided to you by Telstra (including Conditions of Use or Access).</p>
--

(See attached file: *Telstra Duty of Care v33.0a.pdf*)

(See attached file: *Telstra Map Legend v4_0c.pdf*)

(See attached file: *AccreditedPlantLocators 2025-12-17b.pdf*)

(See attached file: *265982516.pdf*)



	<p>Report Damage:https://service.telstra.com.au/customer/general/forms/report-damage-to-telstra Ph - 13 22 03 Email - Telstra.Plans@team.telstra.com Planned Services - ph 1800 653 935 (AEST bus hrs only) General Enquiries</p>	<p>Sequence Number: 265982516</p>
<p>TELSTRA LIMITED A.C.N. 086 174 781</p> <p>Generated On 22/12/2025 11:35:06</p>		<p>Please read Duty of Care prior to any excavating</p>

The above plan must be viewed in conjunction with the Mains Cable Plan on the following page

WARNING

Telstra plans and location information conform to Quality Level "D" of the Australian Standard AS 5488-Classification of Subsurface Utility Information. As such, Telstra supplied location information is indicative only. Spatial accuracy is not applicable to Quality Level D. Refer to AS 5488 for further details. The exact position of Telstra assets can only be validated by physically exposing it. Telstra does not warrant or hold out that its plans are accurate and accepts no responsibility for any inaccuracy. Further on site investigation is required to validate the exact location of Telstra plant prior to commencing construction work. A Certified Locating Organisation is an essential part of the process to validate the exact location of Telstra assets and to ensure the asset is protected during construction works.

See the Steps- Telstra Duty of Care that was provided in the email response.

Page 1 of 2

Mains Cable Plan

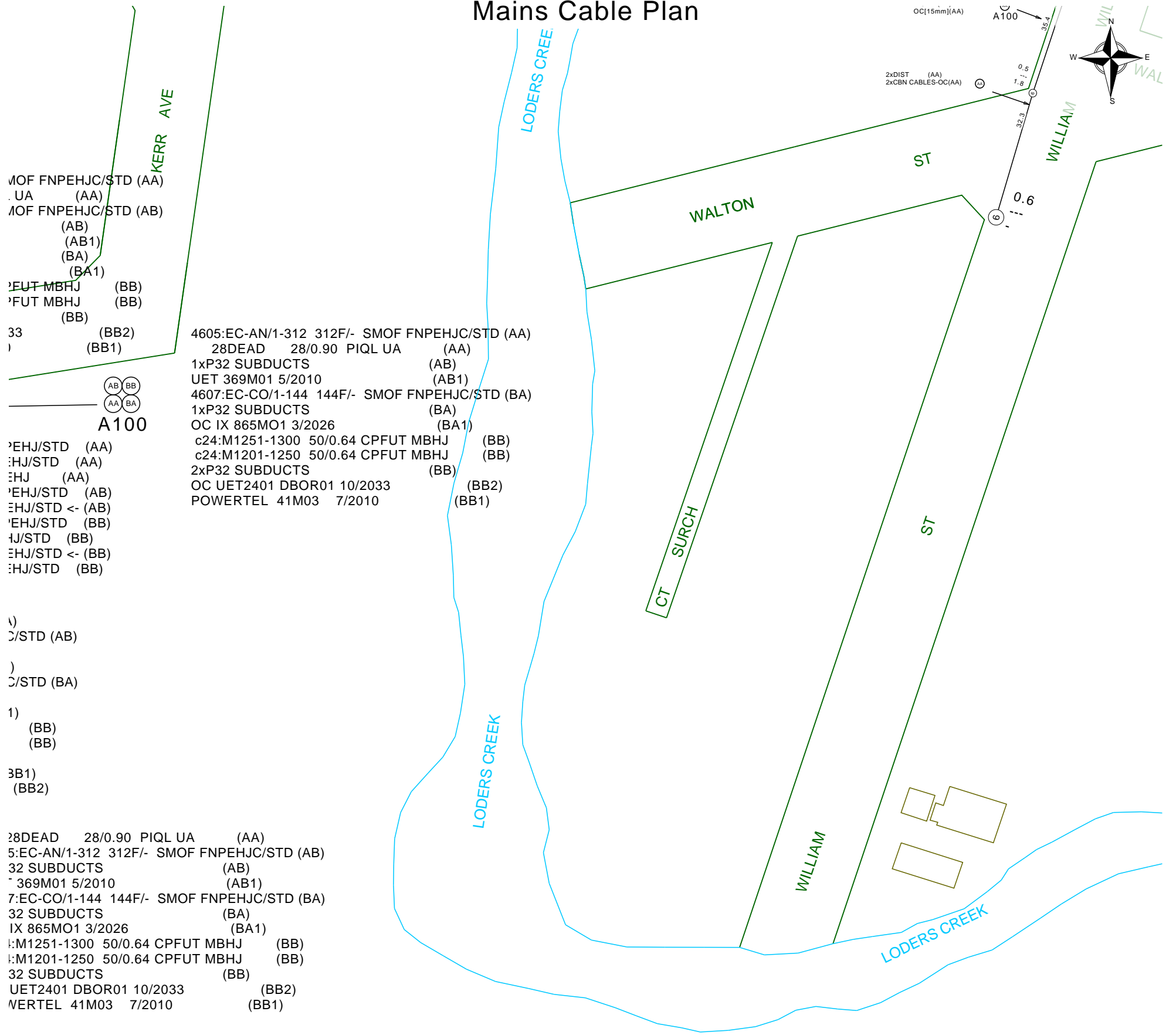

Report Damage: <https://service.telstra.com.au/customer/general/forms/report-damage-to-telstra->
Ph - 13 22 03
Email - Telstra.Plans@team.telstra.com
Planned Services - ph 1800 653 935 (AEST bus hrs only) General Enquiries

Sequence Number: 265982516

Please read Duty of Care prior to any excavating

TELSTRA LIMITED A.C.N. 086 174 781

Generated On 22/12/2025 11:35:08

The above plan must be viewed in conjunction with the Mains Cable Plan on the following page

WARNING

Telstra plans and location information conform to Quality Level "D" of the Australian Standard AS 5488-Classification of Subsurface Utility Information. As such, Telstra supplied location information is indicative only. Spatial accuracy is not applicable to Quality Level D. Refer to AS 5488 for further details. The exact position of Telstra assets can only be validated by physically exposing it. Telstra does not warrant or hold out that its plans are accurate and accepts no responsibility for any inaccuracy. Further on site investigation is required to validate the exact location of Telstra plant prior to commencing construction work. A Certified Locating Organisation is an essential part of the process to validate the exact location of Telstra assets and to ensure the asset is protected during construction works.

See the Steps- Telstra Duty of Care that was provided in the email response.

General Information



Telstra highly recommends using Certified Locators.

For more info contact a [CERTLOC Certified Locating Organisation \(CLO\)](#) or Telstra Location Intelligence Team 1800 653 935



Before you Dig Australia – BEST PRACTISE GUIDES
<https://www.byda.com.au/before-you-dig/best-practice-guides/>



OPENING ELECTRONIC MAP ATTACHMENTS –

Telstra Cable Plans are generated automatically in either PDF or DWF file types.
Dependent on the site address and the size of area selected.
You may need to download and install free viewing software from the internet e.g.



DWF Map Files (all sizes over A3)
Autodesk Viewer (Internet Browser) <https://viewer.autodesk.com/> or
Autodesk Design Review <http://usa.autodesk.com/design-review/> for DWF files.
(Windows PC)



PDF Map Files (max size A3)
Adobe Acrobat Reader <http://get.adobe.com/reader/>



Telstra New Connections / Disconnections
13 22 00



Telstra Protection & Relocation: 1800 810 443 (AEST business hours only).
[Email](#)
Telstra Protection & Relocation Fact Sheet: [Link](#)
Telstra Protection & Relocation Home Page [Link](#)



Telstra Aerial Assets Group (overhead network)
1800 047 909

Protect our Network:

by maintaining the following distances from our assets:

- 1.0m Mechanical Excavators, Farm Ploughing, Tree Removal
- 500mm Vibrating Plate or Wacker Packer Compactor
- 600mm Heavy Vehicle Traffic (over 3 tonnes) not to be driven across Telstra ducts or plant.
- 1.0m Jackhammers/Pneumatic Breakers
- 2.0m Boring Equipment (in-line, horizontal and vertical

Before You Dig Australia

Think before you dig

This document has been sent to you because you requested plans of the Telstra network through Before You Dig Australia (BYDA).

If you are working or excavating near telecommunications cables, or there is a chance that cables are located near your site, you are responsible to avoid causing damage to the Telstra network.

Please read this document carefully. Taking your time now and following the **BYDA's Best Practices and 5 Ps of Safe Excavation** <https://www.byda.com.au/before-you-dig/best-practice-guides/>

can help you avoid damaging our network, interrupting services, and potentially incurring civil and criminal penalties.

Our network is complex and working near it requires expert knowledge. Do not attempt these activities if you are not qualified to do so.



Disclaimer and legal details

*Telstra advises that the accuracy of the information provided by Telstra conforms to Quality Level D as defined in AS5488-2013.

It is a criminal offence under the Criminal Code Act 1995 (Cth) to tamper or interfere with telecommunications infrastructure.

Telstra will also take action to recover costs and damages from persons who damage assets or interfere with the operation of **Telstra's** networks.

By receiving this information including the indicative plans that are provided as part of this information package you confirm that you understand and accept the risks of working near **Telstra's** network and the importance of taking all the necessary steps to confirm the presence, alignments and various depths of **Telstra's** network. This in addition to, and not in replacement of, any duties and obligations you have under applicable law.

When working in the vicinity of a telecommunications plant you have a "Duty of Care" that must be observed. Please read and understand all the information and disclaimers provided below.

The Telstra network is complex and requires expert knowledge to interpret information, to identify and locate components, to pothole underground assets for validation and to safely work around assets without causing damage. If you are not an expert and/or qualified in these areas, then you must not attempt these activities. Telstra will seek compensation for damages caused to its property and losses caused to Telstra and its customers. Construction activities and/or any activities that potentially may impact on Telstra's assets must not commence without first undertaking these steps. Construction activities can include anything that involves breaking ground, potentially affecting Telstra assets.

If you are designing a project, it is recommended that you also undertake these steps to validate underground assets prior to committing to your design.

This Notice has been provided as a guide only and may not provide you with all the information that is required for you to determine what assets are on or near your site of interest. You will also need to collate and understand all information received from other Utilities and understand that some Utilities are not a part of the BYDA program and make your own enquiries as appropriate. It is the responsibility of the entities arranging for the works to be performed, supervising the works, and undertaking the works to protect Telstra network during excavation / construction works.

Telstra owns and retains the copyright in all plans and details provided in conjunction with the applicant's request. The applicant is authorised to use the plans and details only for the purpose indicated in the applicant's request. The applicant must not use the plans or details for any other purpose.

Telstra plans or other details are provided only for the use of the applicant, its servants, agents, or CERTLOC Certified Locating Organisation (CLO). The applicant must not give the plans or details to any parties other than these and must not generate profit from commercialising the plans or details. If the Applicant is aware of another party or parties about to perform or performing works at the location, it should ensure that the other party or parties have lodged a BYDA enquiry and obtained plans for that location. If you are undertaking excavations works you must follow the 5Ps of Safe Excavation. The 5 Ps of Safe Excavation are set out in the video in the below link.

<https://www.byda.com.au/education/resources/>

Telstra, its servants or agents shall not be liable for any loss or damage caused or occasioned by the use of plans and or details so supplied to the applicant, its servants and agents, and the applicant agrees to indemnify Telstra against any claim or demand for any such loss or damage.

Please ensure Telstra plans and information provided always remains on-site throughout the inspection, location, and construction phase of any works.

Telstra plans are valid for 60 days after issue and must be replaced if required after the 60 days.

Data Extraction Fees

In some instances, a data extraction fee may be applicable for the supply of Telstra information. Typically, a data extraction fee may apply to large projects, planning and design requests or requests to be supplied in non-standard formats. For further details contact Telstra Location Intelligence Team.

Telstra does not accept any liability or responsibility for the performance of or advice given by a CERTLOC Certified Locating Organisation (CLO). Certification is an initiative taken by Telstra towards the establishment and maintenance of competency standards. However, performance and the advice given will always depend on the nature of the individual engagement.

Neither the Certified Locating Organisation nor any of its employees are an employee or agent for Telstra. Telstra is not liable for any damage or loss caused by the Certified Locating Organisation or its employees.

Once all work is completed, the excavation should be reinstated with the same type of excavated material unless specified by Telstra.

The information contained within this pamphlet must be used in conjunction with other material supplied as part of this request for information to adequately control the risk of potential asset damage.

When using excavators and other machinery, also check the location of overhead power lines.

Workers and equipment must maintain safety exclusion zones around power lines

WARNING: Telstra plans and location information conform to Quality Level 'D' of the Australian Standard AS 5488 - Classification of Subsurface Utility Information. As such, Telstra supplied location information is indicative only. Spatial accuracy is not applicable to Quality Level D. Refer to AS 5488 for further details. Telstra does not warrant or hold out that its plans are accurate and accepts no responsibility for any inaccuracy shown on the plans. FURTHER ON SITE INVESTIGATION IS REQUIRED TO VALIDATE THE EXACT LOCATION OF TELSTRA PLANT PRIOR TO COMMENCING CONSTRUCTION WORK. A plant location service is an essential part of the process to validate the exact location of Telstra assets and to ensure the assets are protected during construction works. The exact position of Telstra assets can only be validated by physically exposing them. Telstra will seek compensation for damages caused to its property and losses caused to Telstra and its customers.

Privacy Note

Your information has been provided to Telstra by BYDA to enable Telstra to respond to your BYDA request. Telstra keeps your information in accordance with its privacy statement. You can obtain a copy at www.telstra.com.au/privacy or by calling us at 1800 039 059 (business hours only).

LEGEND



	Leadin terminates at a Customer Address		Cable Jointing Pit Number / Letter indicating Pit type/size
	Exchange Major Cable Present		Elevated Joint (above ground joint on buried cable)
	Pillar / Cabinet Above ground Free Standing		Telstra Plant in shared Utility trench
	Above ground Complex Equipment Please note: Powered by 240v electricity		Aerial cable / or cable on wall
OC	Other Carrier Telecommunication Cable/ Asset. Not Telstra Owned		Aerial cable (attached to joint use Pole e.g., Power Pole)
DIST	Distribution cables in Main Cable Ducts		Marker Post Installed
MC	Main Cable ducts on a Distribution Plan		Buried Transponder
	Blocked or Damaged Duct		Marker Post & Transponder
	Footway Access Chamber (can vary between 1-lid to 12-lid)		Optical Fibre Cable Direct Buried
	NBN Pillar		Direct Buried Cable
	Third Party Owned Network Non-Telstra		nbn owned network

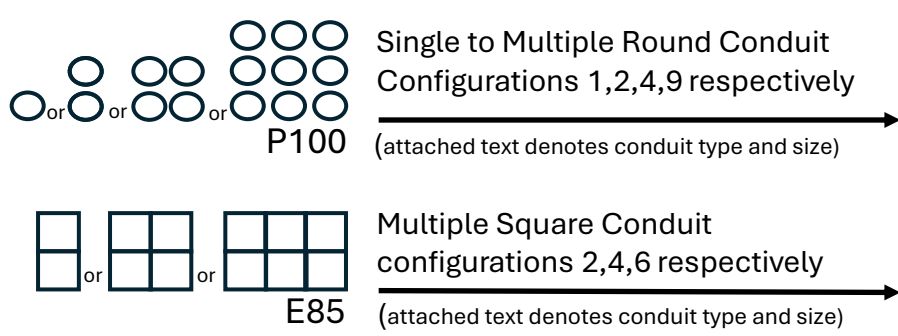

Some examples of conduit type and size:

A - Asbestos cement, P - PVC / Plastic, C - Concrete, GI - Galvanised Iron, E - Earthenware

Conduit sizes nominally range from 20mm to 100mm

P50 50mm PVC conduit
P100 100mm PVC conduit
A100 100mm asbestos cement conduit

Some Examples of how to read Telstra Plans

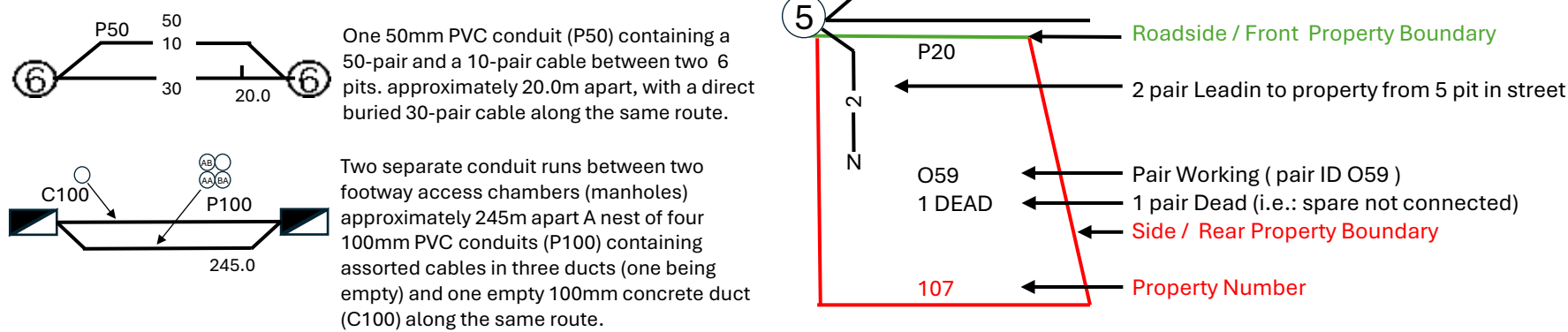

The 5 Ps of Safe Excavation

<https://www.byda.com.au/before-you-dig/best-practice-guides/>

Plan	Prepare	Pothole	Protect	Proceed
Plan your job. Use the BYDA service at least one day before your job is due to begin, and ensure you have the correct plans and information required to carry out a safe project.	Prepare by communicating with asset owners if you need assistance. Look for clues onsite. Engage a Certified Locator.	Potholing is physically sighting the asset by hand digging or hydro vacuum extraction.	Protecting and supporting the exposed infrastructure is the responsibility of the excavator. Always erect safety barriers in areas of risk and enforce exclusion zones.	Only proceed with your excavation work after planning, preparing, potholing (unless prohibited), and having protective measures in place.



End of document

i This document may exclude some files (eg. DWF or ZIP files)

This document was automatically generated at a point-in-time. Be aware that the source information from which this document was created may have changed since it was produced. This document may contain incomplete or out-of-date information. Always check your enquiry details in the BYDA Referral Service for the most recent information. For copyright information refer to individual responses.